



F&M'S DEPARTMENT OF THEATRE AND DANCE PRESENTS

CONCORD FLORAL

A PLAY BY JORDAN TANNAHILL

**GREEN ROOM
THEATRE**

PURCHASE
TICKETS HERE



THURSDAY, NOV. 30 | 7:30 P.M.

FRIDAY, DEC. 1 | 7:30 P.M.

ASL INTERPRETER PRESENT

SATURDAY, DEC. 2 | 2 P.M. & 7:30 P.M.



FRANKLIN & MARSHALL COLLEGE

CONTENT ALERTS

This play is for mature audiences, and contains subject matter including graphic sexual language, reference to a sexual encounter with a minor, drug use, and bullying.

The Theatre & Dance Department Presents:

CONCORD FLORAL

By: Jordan Tannahill

November 30th at 7:30pm

December 1st at 7:30pm

December 2nd at 2:00pm & 7:30pm

Green Room Theatre
Franklin & Marshall College

Directed By	Rachel Anderson-Rabern
Scenic & Lighting Design	Jacob Sikorski
Costume Design	Emily Liberatore
Technical Direction	Rob Marenick
Sound Design	Jake Miller '24
Props Design	Ellie Borghi '24
Assistant Director	Aviva Katz '24
Dramaturg	Emily Hanson '25
Production Stage Manager	Anna Waldstein-Torres '24
Assistant Stage Managers	April Rump '25 and Lola Abel '26

Please do not use cameras or recording devices in the theatre. Please use cellular phones and electronic devices for the virtual program only, and NOT during the performance. Please do not bring food or drinks into the theatre. Note that that this play uses flashing lights, and contains mature content.

DIRECTOR'S NOTE

Last year, we asked continuing theatre students to share ideals, toward modes of theatre they most wanted to explore within the 2023-2024 Theatre season. Ghostly, contemporary, and ensemble-oriented were high on the list, which our department translated into the selection of *Concord Floral*, a piece we are moved to share with you this evening.

Concord Floral comes to us following its 2014 premiere in Toronto; playwright Jordan Tannahill developed it in conversation with a group of professional creatives alongside teenage actors. The teenage actors of that original piece were featured in photographs accompanying the play's publication in *Canadian Theatre Review* in 2015: the portraits of these people sit inside real domestic spaces, real rooms, real fragments of the private lives of these individuals. That specificity is part of what drew me to the play in the first place. In interviews, Tannahill talks about realness hand in hand with what imagination can conjure. *Concord Floral* is a real place, a greenhouse north of Toronto where he partied. He was reading *The Decameron* at the time, a collision of inspiration he shaped into a play exploring the full-throated depth, breadth, and terror of adolescent experience.

Life, and in this case the lived and remembered experiences of adolescence, is multifaceted: it can be perverse, cruel, passionate, innocent, hopeful, sexual, awkward, intellectual, intoxicated, joyful, isolated, mischievous, connected, lost. We have tried to create a world for you in which those complexities all have voices, and blend together into a chorus that needs each note. I am grateful to my exceptional colleague-collaborators and for the generosity and bravery of this group of student actors, designers, and production staff; our conversations and questions have been a delight.

There is so much to explore in this play, with its intertextuality, lyricism, and ghostly magic. One theme that lifts out for me is that of abandonment. This text animates animals and objects, juxtaposed with human characters. All of these nonhuman characters have been, in one way or another, abandoned as the result of human action (or inaction). This suggests an ecological thread throughout the play: what do we expect, both concretely and metaphorically, to happen in our surrounding world if we do nothing? Perhaps the plague of *Concord Floral* is passivity and myopia. Perhaps that's the real image of Death, the frightening spectre that followed us into the theatre, and will follow us out.

DRAMATURG'S NOTE

"Such fear and fanciful notions took possession of the living that almost all of them adopted the same cruel policy, which was entirely to avoid the sick and everything belonging to them. By so doing, each one thought he would secure his own safety."

— Giovanni Boccaccio, *The Decameron*

My name is Emily Hanson, and I am the dramaturg for the F&M Theatre Program production of *Concord Floral*. Dramaturgy is the study of dramatic composition and elements on stage. It is the exploration of both the world of a play, and how the text engages with the world that we live in. As a dramaturg, my primary role has been asking integral questions and researching the necessary information to tell the intended story.

Luckily for me, *Concord Floral* is a very special show, and many of its elements draw from prominent historical premises and works. The playwright, Jordan Tannahill, was inspired by a 14th century Italian novel entitled *The Decameron*. Written by Giovanni Boccaccio, the novel is a series of one hundred stories told by ten teenagers in Florence, Italy who flee the Black Death and hide out in an abandoned villa. The play itself addresses the novel, but I'm most intrigued by the similarities that extend beyond those visual and verbal references.

Structural and thematic aspects of *The Decameron* influenced those in *Concord Floral*. In the physical script, specifically, each character is referenced by an assigned number, 1 through 10, rather than their name. The play consists of ten scenes, akin to the ten nights that the teenagers in *The Decameron* tell stories in the villa. But even deeper, I discovered resemblances of the core ideals at the heart of these two works. The threads of power, love, trickery, iniquity, heartbreak, and death tie the ten scenes of *Concord Floral* together.

A plague, whether it be a real or metaphorical sickness, governs the actions of these teens; they are human, and this play examines this humanity in the face of fear, in the face of themselves and their deepest instincts.

Concord Floral also took inspiration from the theatrical strategies of Bertolt Brecht, a German playwright whose work heavily influenced modern theatre. One of the primary techniques of his dramatic form was breaking the fourth wall, in which actors directly address the audience. Brecht believed in the importance of the ensemble, and equal participation in a show. Often, one actor represented multiple characters, changing dialogue and costumes onstage. Consequently, the main characters in *Concord Floral* are narrators, conveying a story to us, the audience, as teenagers and other figures.

Concord Floral is a snippet of life, a glimpse into the experience of teenagers who aren't perfect, teenagers who are real, who grow, and love, and break hearts, and live. It's a snippet of a plague that infects them, and what might happen if they let go a little too much.

Want to know more? Check out the Know The Show Guide:



CAST LIST

1 (Just Joey)	Aislinn/Amadeus Wallin
2 (Bobolink)	Eesha Gupta
3 (John Cabot)	Lucas Friedman
4 (Forever Irene)	Shoshana Frank
5 (Rosa Mundi)	Amalie Kinney
6 (Nearly Wild)	Jahnel Rodriguez
7 (Couch)	Keith Wattenbarger
8 (Fox)	Alanii Vargas
9 (Greenhouse)	Katherine Chesterman
10 (Bobbie James)	Mei-Lan Holland
Ensemble (Giovanni/GiGi)	Bex Batista
Ensemble (Mujo/Joe)	Faris Grbic
Ensemble (Ophelia)	Lindsay McVail
Ensemble (Zara Webber)	Sora Reynolds

TECHNICAL STAFF

Scenic Charge Artist: Kelly Daigneault

Lighting Board Operator: Ryan Squires '24

Sound Board Operator: Jake Miller '24

Sound Design Consultant: Daniel Etti-Williams

Videographer: Ali Kamanda

Video Assistant: Cassidy Farley '24

Technical Assistants/Set Construction: Anna Waldstein-Torres, Jake Miller, Devin Simitz, Wulf Nash, Daniel Cohen, Yusuf Taha Eker, Eli Komarinski, Ben Bromwell, Morgan Reese, Opeyemi Olarogba, Micki Moore, Christopher Mayo

Electrics Crew: Anna Dong, Melissa Edwards, Bex Batista, Alanii Vargas

Wardrobe Crew: Micki Moore

Laundry Crew: Aurora Toskala

Costume Shop Stitchers: Bex Batista, Cassidy Farley, Elyse Mielke, Micki Moore, Jess Perfit, Sora Reynolds, Kim Rosario, Olha Shapovalenko, Alison Waller

Custom moss embroidery created by costume shop stitcher
Elyse Mielke

ARTISTIC STAFF



Lola Abel (Assistant Stage Manager) is a sophomore from along the MA and RI border. She is an intended double major in biology and technical theatre. Lola is currently a House Advisor in Ware College House. She worked as the production stage manager for F&M Players' *Best of the Worst*. She was also a stagehand

for the Green Room Theatre Club's *Platform 7*. Lola is very grateful for the opportunity to continue technical theatre in college and wishes everyone a wonderful show!



Rachel Anderson-Rabern (Director) (she/hers) is Associate Professor Theatre and Chair of F&M's Theatre and Dance Department, and member of the Stage Directors and Choreographers Society union (SDC). She holds a PhD in Drama from Stanford University, a BA in Theatre and (Russian focus) Literature from Reed College, and studied acting at the Moscow Art Theatre.

Her writing includes the book *Staging Process: The Aesthetic Politics of Collective Performance* (Northwestern University Press, 2020), multiple book chapters, and articles in publications including *Theatre Journal*, *TDR: The Drama Review*, *European Stages*, and *Imagined Theatres*. Her artistic scholarship includes devised work with *Three Sheets*, the theatre company she founded in Lancaster, which most recently co-created the immersive piece *Camp* with the band Featherburn, and *Next Chapter* which won the award for Best Digital Performance at the Philadelphia Fringe Festival in 2022. She has also directed for Pear Avenue Theatre (SF Bay Area), Stanford Repertory Theatre (SF Bay Area), Mountain View Center for the Performing Arts (SF Bay Area), Miracle Theatre Group (Portland OR), and multiple colleges and universities on both coasts. www.rachelandersonrabern.com

Ellie Borghi (Props Designer) is a senior psychology and dance joint major with a theatre minor from Bucks County, PA! This is her first time on a production staff at F&M, but you have likely seen her on stage before! Ellie is current Treasurer of F&M Players, active member of Dance Company, and has been involved in multiple TND shows since freshman year. She is also co-president of F&M Colleges Against Cancer club and General Enrichment Team Leader in the vivarium. Ellie is immensely grateful to her fellow production staff, cast, and crew for collaborating to make *Concord Floral* such an amazing show!



Ryan B Gibbs (Stage Management Mentor) Ryan has worked on several shows on Broadway, Off Broadway and toured ten Broadway Shows to 49 of the 50 states as well as Canada, Austria, and Japan. For three seasons he was the Artistic Director of the Allenberry Playhouse. Ryan recently spent several years as a Producer for Broadway Cares/Equity Fights AIDS. He lives in Lancaster with his wife Amy, sons Anderson and Benjamin and cat Gumbo. Where they also own a small vintage toy shop called Retrosplat! and run a coaching/consulting business called Gibbsology. You can learn more about Ryan from his website: ryanbgibbs.com.





Emily Hanson (Dramaturg) (she/they) is a junior at F&M from Mahwah, NJ. She is a creative writing major and theatre minor. She is honored to be the dramaturg for *Concord Floral*, and not just because it's a fun word. This is the first theatre production she's working on since her time as an ensemble member in *The Lion King Jr.* in eighth grade, and it has been an extremely gratifying experience. She is so incredibly proud of the cast and crew, and she hopes you enjoy this thrilling, meaningful, truly amazing production.



Ali Biko Sulaiman Kamanda (Videographer) is an award-winning filmmaker and social entrepreneur from Sierra Leone, West Africa. Kamanda's passion is in telling stories about the plight of African youth, to portray those stories through the medium of film, and to use those films to uplift communities from his home country. He is a graduate of UNC Chapel Hill, with a Communications degree.

In 2011 he established BIKO Studios, a cross-cultural film production company. His original film SALAY won Best Director, Best African Film, Best Human Rights Film and an Award of Excellence for Social Justice. He is also the President of Salone Rising, a not-for-profit organization that supports MamaLand, a children's community for orphans. The organization also provides micro-financing and mentoring resources to small business owners in rural Sierra Leone.

Aviva Katz (Assistant Director) is a senior from Los Angeles, CA, majoring in theatre and government, with a certificate in education. She has previously performed in TND's *Same Song Different Key* (Stella), *Tale of a West Texas Marsupial Girl* (Lacey Rubertree), *The Winter's Tale* (Shepherd), and *Head Over Heels* (Ensemble), plus the Spring '22, Fall '22, and Spring '23 Dance Concerts. Her club theatre production credits are F&M Players' *9 to 5* (Maria/Doctor), *Anything Goes* (Assistant Director), *Footloose* (Coach Dunbar/Principal), and *Lost in Love* (Soprano), plus GRTC's *Who's Afraid of Virginia Woolf* (Martha). Additionally, she's the current F&M Players President and Green Room Theatre Club Vice President, and she will be directing the GRTC's production of *Little Women* in the spring. Beyond theatre, Aviva's largest involvement is with the F&M Jewish community, as current president of Chabad. Aviva is extremely grateful for the opportunity to direct alongside her mentor Rachel Anderson-Rabern, and with such a wonderful and enjoyable cast and crew. She sends her love to the entire team, and she hopes you enjoy the end product!



Emily Liberatore (Costume Designer) is a costume designer and technician from Hamburg, New Jersey. She is the resident costume designer and costume shop manager at F&M College. She holds her BFA in Theatre Design and Technology from Syracuse University, her MFA in Dramatic Arts Costume Design from University of Connecticut, and MS in Environmental Management from University of Connecticut. Recent Costume Design Credits include *Jersey Boys* at Forestburgh Playhouse, *The Cake* at Cortland Repertory Theatre. and *Metamorphoses* at Connecticut Repertory Theatre. She is so excited to be part of this production!



Rob Marenick (Technical Director) earned his MFA. in production design and technology from Ohio University. His experiences have included technical direction and lighting design for over 150 productions. His work history includes Lawrence University in Appleton, WI, Oberlin College in

Oberlin, OH, and Winthrop University in Rock Hill, SC as well as many other producing organizations. Rob is a strong advocate of the liberal arts educational experience and believes strongly in the role theatre plays in this type of education.



Jake Miller (Sound Designer) is the Sound Designer and Sound Board Operator for *Concord Floral*, and he is scared. He has seen the show many times now, designed the sound necessary to put it on, and yet, he sits there with dread awaiting each run. He is scared and he doesn't know how to tell other people. You'd think that

familiarity with the script and show would save him but alas. For your sakes, he will suffer in silence, pressing his button and doing his job. Jake has loved the experience he has gained as a designer and values this experience greatly! Thank you to the entire cast and production staff for encouraging his testing of silly sounds and songs.

April Rump (Assistant Stage Manager) is a junior from Chambersburg, PA. She is a psychology major and an intended German minor. She is currently a House Advisor (HA) for Brooks College House (Brooks House BEST HOUSE) and president of the Rumspringas, F&M's only comedy improv club! She has been involved with theatre since freshman year of college with F&M Players' Broadway Revue, acting in *I Know What We Are Going To Do Today* and *Best of The Worst*. Also, this is her first year doing stage crew! She wants to give a big thanks to her friends and family and mentors for helping her learn the ropes of theater! She hopes you enjoy the show!



Shaila Schmidt (Dramaturgy Mentor) is a dramaturg and theater educator interested in how we tell stories, why we tell stories the ways we do, and whose story gets told. She received her MFA in Dramaturgy from the University of Massachusetts-Amherst where she wrote her thesis on intersectional feminism, empathy, comedy, and Mindy Kaling. She has been dramaturg for over ten years and currently teaches playwriting and non-Western theatre history courses at George Mason University and the University of New Mexico.



CAST



Jacob Sikorski (Scenic/Lighting Designer) is a designer for theatre, dance, opera, and corporate events and is the Resident Scenic/Lighting Designer for the Department of Theatre and Dance at Franklin & Marshall College. Previous design credits include: *My Mother's Three Mothers* (Lighting, Lost Nation Theatre), *Fiddler on the Roof* (Lighting, Friends

Seminary NYC), *Sense and Sensibility* (Lighting, CCSU), *The Crucible* (Scenic, Parallel45 Theatre), and *Cabaret* (Scenic, Parallel45 Theatre). Additionally, Jacob has worked extensively in video production, working as a technician with the Public Theatre in NYC and around the country with Production Resource Group.



Anna Waldstein-Torres (Production Stage Manager) is a Senior from Catonsville, MD. They are a technical theatre major, and WGSS minor. Department credits include Production Stage Manager for *Same Song Different Key*, as well as PSM for *Tale of a West Texas Marsupial Girl*, and Assistant Stage Manager for *The Winter's Tale*.

Green Room Theatre Club credits include ASM/Technical Director/Props Designer for *The Ballad of Maria Marten*, Stage Manager for *Eurydice*, and ASM/Scenic Designer for *Death Trap*. F&M Players credits include Co-Scenic Design for *9 to 5* and *Best of the Worst*. Anna is super proud of their *Concord* team, and hopes you enjoy the show!

Bex Batista (Ensemble/Giovanni) is a sophomore from NY. Bex is an intended joint theatre and WGSS major. This is Bex's second performance at F&M—the previous one being *Tale of a West Texas Marsupial Girl* (Ensemble). Bex was also in the Spring Dance Concert last spring and recently performed in the Fall Dance Concert. When she's not performing on stage, she's behind the scenes at the costume shop and in lighting and set design. She enjoys engaging in all aspects of performance art and would like to thank the faculty and staff of the theatre department who have mentored her. She would also like to thank the cast and crew for making this experience fun and exciting, as well as her family for supporting her.



Katherine Chesterman (9/Greenhouse) is a senior from a little bit of everywhere. Katherine is a neuroscience major with an emphasis in pre-med. Currently, Katherine is the president of Gaming Society, the best club to play the most obscure and most loved board games! This is Katherine's first department production, but has been in several Green Room Theatre Club shows, such as: *Who's Afraid of Virginia Woolf?* (Martha), *You're a Good Man Charlie Brown* (Linus), *Deathtrap* (Helga ten Dorp), and *Eurydice* (Understudy). Katherine would love to thank every cast and crew member who helped to put this production together and facilitated a warm and loving environment during rehearsals.





Shoshana Frank (4/Forever Irene) (she/her) is a senior animal behavior and theatre double major from outside of Chicago, IL. She has been acting in plays and musicals since fifth grade, with a couple of her favorite productions being *The Addams Family* (Wednesday Addams), *13 the Musical* (Patrice), and *Pippin* (Berthe).

he has also explored different technical aspects of theatre including directing, playwriting, and stage crew. Her directorial and playwriting debut was *Platform 7* with the Green Room Theatre last fall. When not at rehearsal, she is probably in LSP working, volunteering, and doing research in the vivarium. She is thrilled to once again be performing with the TND department, and would like to extend her gratitude to Rachel and the whole cast and production team of *Concord Floral*. She hopes you enjoy the show!



Lucas Friedman (3/John Cabot) is a senior from NJ majoring in business and minoring in theatre. He is a member of the Harbaugh Association, Gaming Society, and WFNM Radio. He also works as a Development Intern for Prima Theatre. This is his first performance at Franklin and Marshall, and he is excited to be a part of the show. He wants to thank Rachel

Anderson-Rabern and his friends at Arts House for encouraging him to pursue theatre. He hopes you enjoy the production and leave the theatre a little spooked.

Faris Grbic (Ensemble/Mujo) is a first-year student from Boise, ID. He intends to major in public health on the biology track and is considering a minor in German, as he has recently returned from an exchange year in Düren, Germany. *Concord Floral* is Faris' first production and he is very excited to be a part of the cast, hoping to explore theatre further during his time at F&M. He looks forward to building community at the college as he continues to try out new extracurricular activities and clubs. Faris is very happy with the work put into *Concord Floral* thus far and hopes you enjoy the show!



Eesha Gupta (2/Bobolink) is a sophomore from Reisterstown, MD. They are thinking about majoring in English (creative writing) and minoring in sociology and theatre, but ultimately, they have no idea what they want to do with their life. Eesha was recently in F&M Players' production of *9 to 5* (Tinsworthy/Ensemble) and the Green Room Theatre Club's production of *Eurydice* (Orpheus). She also sings with the Chamber Singers ensemble at F&M. She is honored to have the opportunity to work with all of the lovely humans who brought this show to life and incredibly grateful for everything she's learned throughout the semester. Eesha is so proud of every single person in the cast and crew, and he hopes you enjoy the show!





Mei-Lan Holland (10/Bobbie James) is a senior theatre and psychology major from South Orange, NJ. You may have seen her in other productions on campus like *Eurydice*, *9 To 5: The Musical*, or *Tale of A West Texas Marsupial Girl*. She is so excited to tell this story with such a talented and energetic cast. Many thanks to her

family, friends, cast and crew mates for their continuous support.



Amalie Kinney (5/Rosa Mundi) is a sophomore from Port Deposit, MD. She is exploring majors, and finds herself most drawn to the fields of psychology, sociology, and film/media. She enjoys wearing many hats on campus, including being a House Advisor (Roschel College House), an editor/designer for

FEM&M, and a representative on the sophomore class cabinet. Involved in theatre since 8th grade, she jumped into the F&M theatre scene with a role as Alice in the Green Room Theatre's production of *Platform 7* last fall, as well as backstage support for two other productions, *Eurydice* and *Same Song Different Key*. Amalie is very excited for y'all to see the show and she wishes to thank the cast, crew, and especially Rachel Anderson-Rabern for making this experience so full of growth, love, and laughter.

Lindsay McVail (Ensemble/Ophelia) is a first-year from Merion, PA. She is currently undeclared in her major. This is her first production with F&M, but she has been participating in theatre since Elementary school. She is so excited to perform in more F&M shows throughout her next four years. She would like to thank the cast and crew of *Concord Floral* for being so welcoming!



Sora Reynolds (Ensemble/Zara Webber) is a Freshman at F&M coming from Maine. This is her first show with the theatre department. She has done many theatre productions before, including at her high school. Her most recent roles include the Courtesan in *Comedy of Errors*, Bilbo Baggins in *The Hobbit*, and Lady Capulet in *Romeo and Juliet*. Sora is excited to be a part of the ensemble in this eerie show, and hopes you enjoy it!





Jahnel Rodriguez (6/Nearly Wild) is a junior from Bucks County, PA. She is an English major, and a dance and religious studies minor. She has participated in several TND productions at F&M including *The Winter's Tale* (Archidamus), *Same Song Different Key* (Christine), and now *Concord Floral*. She is a proud member of the F&M Dance Company, and has also choreographed for F&M Players Club productions such as *9 to 5*, *Broadway Revue: The Best of the Worst*, and *Heathers the Musical*. Last but not least, she is a proud member of the Rumspringas Improv Troupe. She would like to thank her friends and family for all of their lovely support. She hopes you enjoy the show, and leave feeling a bit unsettled (but in a good way)!



Alanii Vargas (8/Fox) is a sophomore from Miramar, FL who intends to joint-major in theatre and film and media studies. She has done some film and acting work during high school and freshman year of college, becoming mesmerized with acting as a whole. She has created and starred in a few student and production short films and intends

to continue making more! She is currently exploring different aspects of theatre making and is very excited to see what is ahead!

Aislinn/Amadeus Wallin (1/Just Joey) is hella excited to be performing in their first ever TND show! His previous F&M theater creds include GRTC's *Six Degrees of Separation* (Rick, Geoffrey) and *Platform 7* (Caroline). She is ever so thankful for the show's uber talented cast and intimidatingly adept production team, as well as their supportive ass parents and ever so loving friends. Shout out to their dumb dog and dumber cat, true emotional support. He hopes everybody enjoys the show and can appreciate the hard work that went into making this spooky dooky play as swag as it is >:3 !



Keith Wattenbarger (7/Couch) is a sophomore from Brooklyn, NY, and he is thrilled to be taking the stage once more in *Concord Floral*, his second TND production. He is planning on majoring in either English literature or government or both, who knows). You may have seen him last semester as Trent in F&M's play *Same Song, Different Key*, or performing at improv shows with the Rumspringas. After many months of work, he is so excited for everyone to see *Concord Floral*. He would like to thank the incredible cast and crew that made it possible, as well as the entire F&M theatre community for creating such a welcoming space for newcomers.



THANK YOU TO:

Fulton Theatre

Dr. Rachel Joseph

Holly Andrew

Dr. Susanne Shawyer

The Fridge

COMING SOON...

February 29 - March 3:
Student New Works Festival
featuring
Spring Theatre Production
Craiglist: Missed Connections

April 18 - 20:
Spring Dance Concert
Student Choreographed

April 25:
Senior Showcase

LAND ACKNOWLEDGEMENT

We gather this evening on the homeland of Native peoples whose history is integral to our past and present, but long denied. In addition to the Susquehannock who lived here in the 17th century, this land was home to the Lenape, Nanticoke, Piscataway, Seneca and Haudenosaunee Confederacy, Shawnee, and others throughout millennia. We acknowledge that Franklin & Marshall College's presence here is a direct legacy of settler colonialism. As a College community, we commit ourselves to the ongoing work of acknowledging and respecting those who came before us on these lands, and to act collectively in support of Native communities.

EMERGENCY EXITS

In case of an emergency, please note the locations of the exits in the theatre. Use the diagram to locate those nearest to your seat, with the stage being oriented at the top.

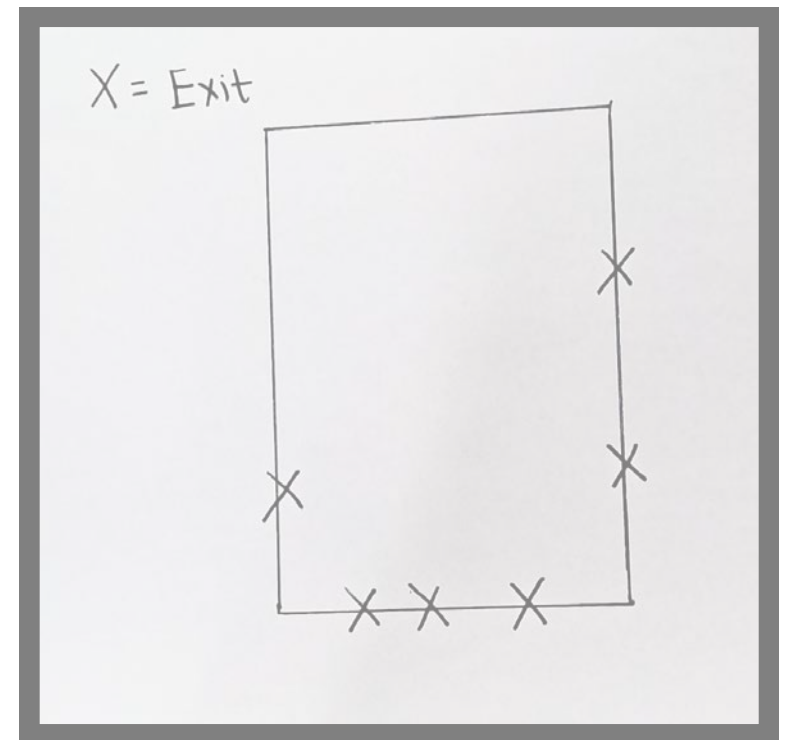

STAFF OF TND FALL 2023

TND Department Chair: Rachel Anderson-Rabern

Theatre Director: Rachel Anderson-Rabern

Dance Directors: Jennifer Conley, Pamela Vail

Playwright: Brian Silberman

Costume Designer: Emily Liberatore

Lighting and Scenic Designer: Jacob Sikorski

Technical Director: Robert Marenick

Production and PR Manager: Bonnie Bosso

Department Coordinator: Megan Keller

House Manager: Leslie Sullivan

Assistant to Production Manager: Aviva Katz '24

Graphics Assistant: Makayla Gayden '24

Senior Box Office Agent: Abby Metcalf '25

Box Office Customer Agents: Makayla Gayden '24,

Aviva Katz '24, Abby Metcalf '25, Casey Shader '26,

Ryan Squires '24, Logan Velez '27